

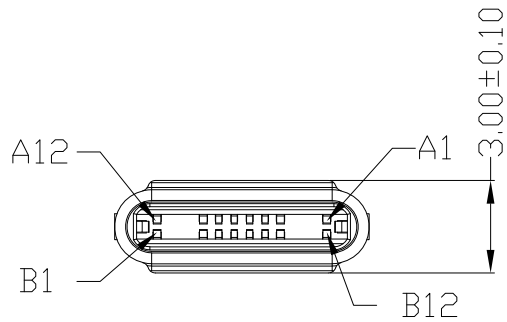

RoHS
Compliant
2002/95/EC

REV.	ECN.	NO.	APPD.

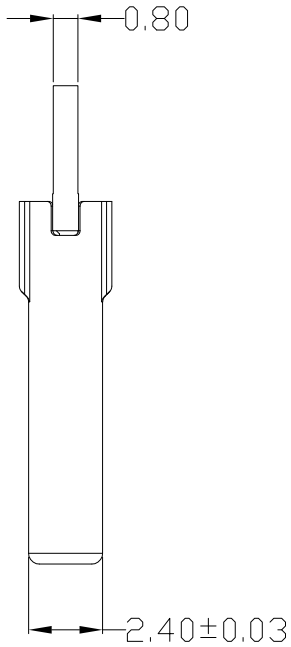
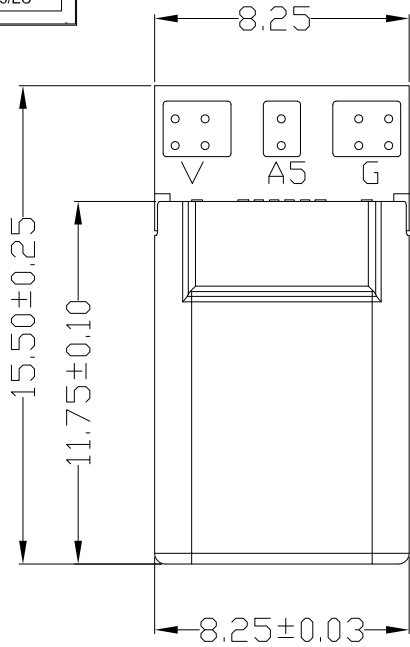

PIN A1、A12、B1、B12、SHELL	GND
PIN A4、A9、B4、B9	VCC
PIN A5	CC
PIN A6	短路
PIN B7	短路

NOTES:

1.ELECTRICAL:

- 1)VOLTAGE CURRENT RATING:3A, 20V DC;
- 2)INSULATION RESISTANCE:100MΩ MIN;
- 3)CONTACT RESISTANCE:40mΩ Max FOR INITIAL,10mΩ Max AFTER TEST.
- 4)WITHSTANDING VOLTAGE:250V AC;
- 5)OPERATING TEMPERATURE:-30°C TO +85°C.

2.MECHANICAL:

- 1)MATING FORCE:5N~20N MAX.
- 2)UNMATING FORCE:8N~20N(INITIAL)
6N~20N(AFTER 10,000 CYCLES) MIN.
- 3)DURABILITY: 10,000 CYCLES

3.DIMENSIONS MARKED "▼"

TO BE CHECKED BY Q.C & IPQC.

4.PART NO.
USCM-161MN-4BSD08-046

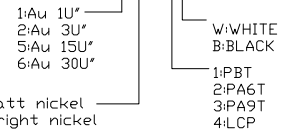

NO	PARTS	MATERIAL	QTY	FINISHING	X.	±0.25	X.*	±3*	UNITS	mm
5					X.	±0.25	X.*	±3*	UNITS	mm
4	HOOK	STAINLESS STEEL	1	PLATED TIN	.X	±0.20	.X.*	±2*	MAT'L	
3	SHELL	STAINLESS STEEL	1	PLATED NICKEL	.XX	±0.15	.XX.*	±1*	SEE NOTE	
2	TERMINAL	COPPER ALLOY	16	PLATED GOLD/TIN	.XXX	±0.08			FINISH	
1	HOUSING	LCP+30%GF	1	UL94V-0					SEE NOTE	
					THESE DRAWINGS AND SPECIFICATIONS ARE THE PROPERTY OF ACCURATE INNOTECH INC AND SHALL NOT BE REPRODUCED, COPIED OR USED IN ANY MANNER WITHOUT THE PRIOR WRITTEN CONSENT OF ACCURATE INNOTECH INC				Q'TY	

雅安科技有限公司 ACCURATE INNOTECH INC.			
TITLE:	USB TYPE CM 2.0 16PIN 插针式 拉伸壳 C TO C	PART NO.:	USCM-16XMN-4BSD08-046
DR:	Ricky 2023/05/08	DWG NO.:	AII-SD08-046
CHKD:	Ricky 2023/05/08	SCALE	1:1
APPD:		SHEET	1/1
		REV.	B
		CUSTOMER DRAWING	