



RoHS  
Compliant  
2002/95/EC

| REV. | ECN. | NO. | APPD. |
|------|------|-----|-------|
|      |      |     |       |
|      |      |     |       |
|      |      |     |       |

|         |     |  |  |      |      |    |    |      |      |  |  |     |
|---------|-----|--|--|------|------|----|----|------|------|--|--|-----|
| CONTACT | A12 |  |  | A9   | A8   | A7 | A6 | A5   | A4   |  |  | A1  |
| DEFINE  | GND |  |  | VBUS | SUB1 | D- | D+ | CC   | VBUS |  |  | GND |
| CONTACT | B1  |  |  | B4   | B5   | B6 | B7 | B8   | B9   |  |  | B12 |
| DEFINE  | GND |  |  | VBUS | CC   | D+ | D- | SUB2 | VBUS |  |  | GND |

焊板2.0系列，料号/贴料说明：

Type C 2.0 DTG  
焊板料号：042

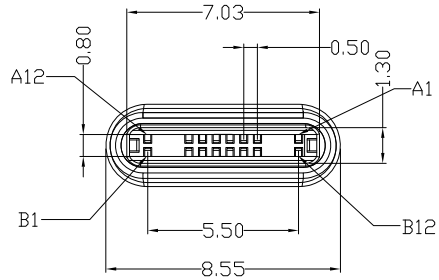

A1.B1.A12.B12.SHELL GND  
A4.B4.A9.B9. VBUS  
A5 CC  
A6 D+  
A7 D-

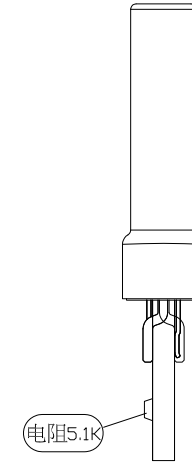
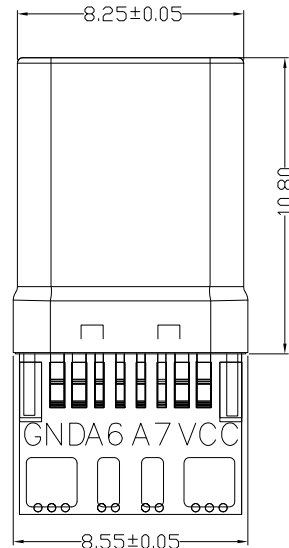
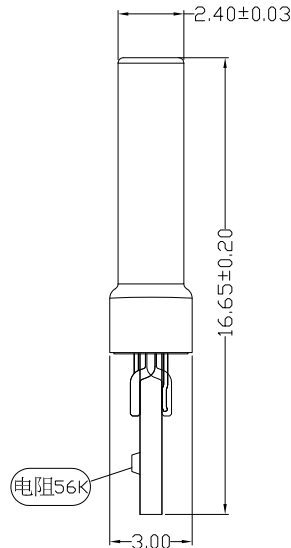
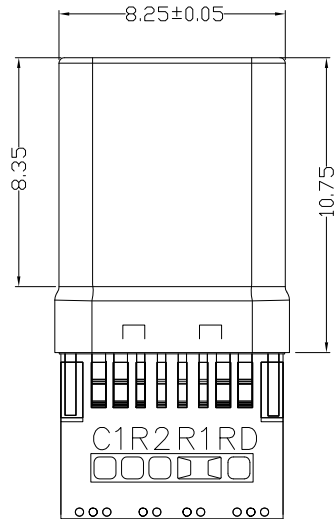

NOTES:

1.ELECTRICAL:

- 1)CURRENT RATING: 3AMP MAX;
- 2)INSULATION RESISTANCE: 100MΩ MIN;
- 3)CONTACT RESISTANCE: 30mΩ MAX;
- 4)WITHSTANDING VOLTAGE: 250V AC;
- 5)OPERATING TEMPERATURE:-30°C TO +85°C.

2.Mechanical:

- 1)Mating Force: 5N~20N
- 2)Unmating Force: 8N~20N
- 3)Durability: 10,000 cycles

3.DIMENSIONS MARKED "▼"  
TO BE CHECKED BY Q.C & IPQC.

4.PART NO.

USCM-16\*MM-4BSD06-04\*

1:1U\*  
2:1A 3U\*  
5:1A 15u\*  
6:1A 30U\*  
W:WHITE  
B:BLACK  
1:PBT  
2:PA6T  
3:PA9T  
4:LCP  
2:0n-The-Go  
5:3A  
MN:Matt nickel  
BN:Bright nickel

|    |          |                 |     |      |       |     |     |          |                 |
|----|----------|-----------------|-----|------|-------|-----|-----|----------|-----------------|
| 5  |          |                 |     | X.   | ±0.25 | X.* | ±3* | UNITS    | mm              |
| 4  | HOOK     | STAINLESS STEEL | 1   | .X   | ±0.15 |     |     | MAT'L    | PLATED TIN      |
| 3  | SHELL    | STAINLESS STEEL | 1   | .XX  | ±0.08 |     |     | SEE NOTE | PLATED NICKEL   |
| 2  | TERMINAL | COPPER ALLOY    | 16  | .XXX | ±0.03 |     |     | SEE NOTE | PLATED GOLD/TIN |
| 1  | HOUSING  | LCP+30%GF       | 1   |      |       |     |     |          | UL94V-0         |
| NO | PARTS    | MATERIAL        | QTY |      |       |     |     |          | FINISHING       |

THESE DRAWINGS AND SPECIFICATIONS ARE THE PROPERTY OF ACCURATE INNOTECH INC AND SHALL NOT BE REPRODUCED, COPIED OR USED IN ANY MANNER WITHOUT THE PRIOR WRITTEN CONSENT OF ACCURATE INNOTECH INC

|  |  |                                    |                  |
|--|--|------------------------------------|------------------|
| 雅安科技有限公司<br>ACCURATE INNOTECH INC.     |  |                                    |                  |
| TITLE:<br>USB TYPE CM 2.0 16pin<br>拉伸壳 |  | PART NO.:<br>USCM-16XXN-4BSD06-04X |                  |
| DR:<br>Ricky 2019/08/22                |  | DWG NO.:<br>AII-SD06-04X           |                  |
| CHKD:<br>Ricky 2019/08/22              |  | SCALE                              | SHEET            |
| APPD:                                  |  | 1:1                                | 1/1              |
|  |  | REV.                               | CUSTOMER DRAWING |
|  |  | B                                  |                  |