

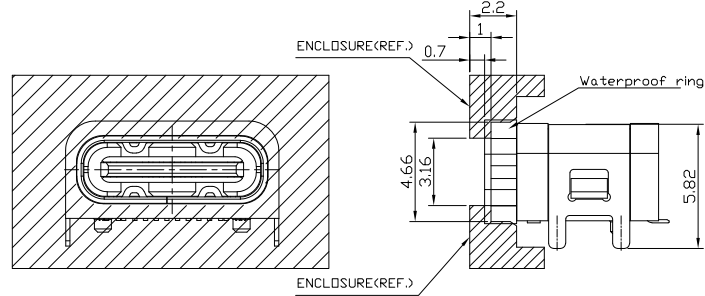

RoHS Compliant
2002/95/EC

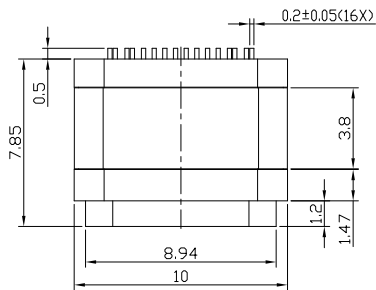

REV.	ECN.	NO.	APPD.



RECOMMENDED SCHEMATIC DRAWING OF CONNECTOR MATCH CHASSIS

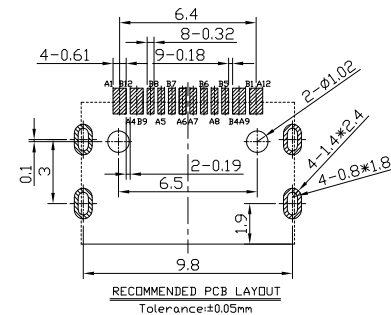
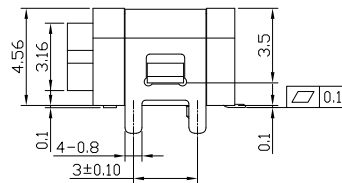
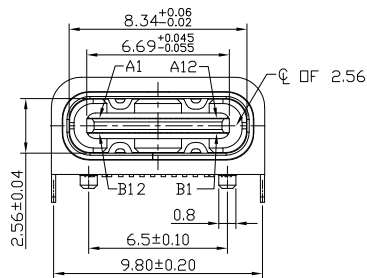

RECOMMENDED PCB LAYOUT
Tolerance:±0.05mm

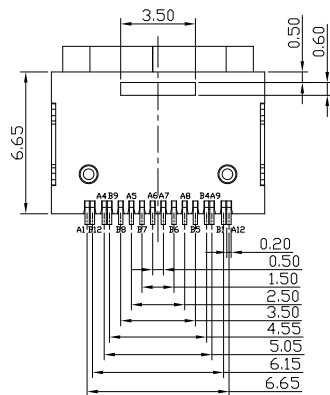

USB TYPE-C PIN ASSIGNMENTS

PIN NUMBER	SIGNAL NAME	PIN NUMBER	SIGNAL NAME
A1	GND	B12	GND
A4	VBUS	B9	VBUS
A5	CC1	B8	SBU2
A6	Dp1	B7	Dn2
A7	Dn1	B6	Dp2
A8	SBU1	B5	CC2
A9	VBUS	B4	VBUS
A12	GND	B1	GND

NOTES:

- ELECTRICAL:
 - CURRENT RATING: 5.0A MAX.
 - INSULATION RESISTANCE: 100MΩ MIN;
 - CONTACT RESISTANCE: 40mΩ MAX;
 - WITHSTANDING VOLTAGE: 100V AC
 - OPERATING TEMPERATURE:-30°C TO +85°C.
- Mechanical:
 - Mating Force: 5N~20N
 - Unmating Force: 8N~20N
 - Durability: 10,000 cycles
- DIMENSIONS MARKED "▼"
TO BE CHECKED BY Q.C & IPQC.

4.PART NO.

UWCF-161N-4BVI18

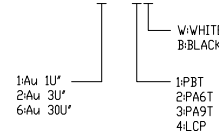

6	O-RING	SILICONE RUBBER	1	BLACK	x.x ±0.30	x.* ±10'	UNITS	mm
5	SHELL	STAINLESS STEEL	1	PLATED NICKEL	.xx ±0.20	.x' ±8'	MAT'L	
4	SHIELD PLATE	STAINLESS STEEL	1	PLATED NICKEL	.xxx ±0.10	.xx' ±5'	SEE NOTE	
3	CONTACT	COPPER ALLOY	16	PLATED GOLD/NICKEL			FINISH	
2	SHELL HOUSING	LCP+30%GF	1	UL94V-0			SEE NOTE	
1	HOUSING	LCP+30%GF	1	UL94V-0			Q'TY	
NO	PARTS	MATERIAL	QTY	FINISHING				

THESE DRAWINGS AND SPECIFICATIONS ARE THE PROPERTY OF ACCURATE INNOTECH INC AND SHALL NOT BE REPRODUCED, COPIED OR USED IN ANY MANNER WITHOUT THE PRIOR WRITTEN CONSENT OF ACCURATE INNOTECH INC

雅安科技有限公司 ACCURATE INNOTECH INC.			
TITLE: USB TYPE CF 单排16P 四脚插板上防水型		PART NO.: UWCF-16XN-4BVI18	
DR: Ricky 2022/12/08		DWG NO.: AII-VI18	
CHKD: Ricky 2022/12/08		SCALE: 1:1	SHEET: 1/1
APPD:		REV.: B	CUSTOMER DRAWING